Mortlake Brewery Community Group

A new school on the Brewery site?

18th March 2019

AGENDA

1. Welcome and Introductions

2. Overview and Consequence of Proposed Development

3. School Demand and Impact on Existing Schools

4. Close and Status Update

1. Welcome and Introductions

2. Overview and Consequence of Proposed Development

3. School Demand and Impact on Existing Schools

4. Close and Status Update

STAG BREWERY SITE



STAG BREWERY SITE – PLANNING APPLICATION



- Sports Fields
- OOLTI Designation - Townscape Value
- Trees TPOs
- Safety at Mortlake Crossing - NR
- Traffic - 50% AM Peak
- Chalker's Corner - Disruption (£5.36m & £2.85m)
- Chertsey Court - Pollution & OOLTI
- Sub-Optimal Site Allocation - 1.89Ha.

STAG BREWERY SITE – SECONDARY SCHOOL SITE

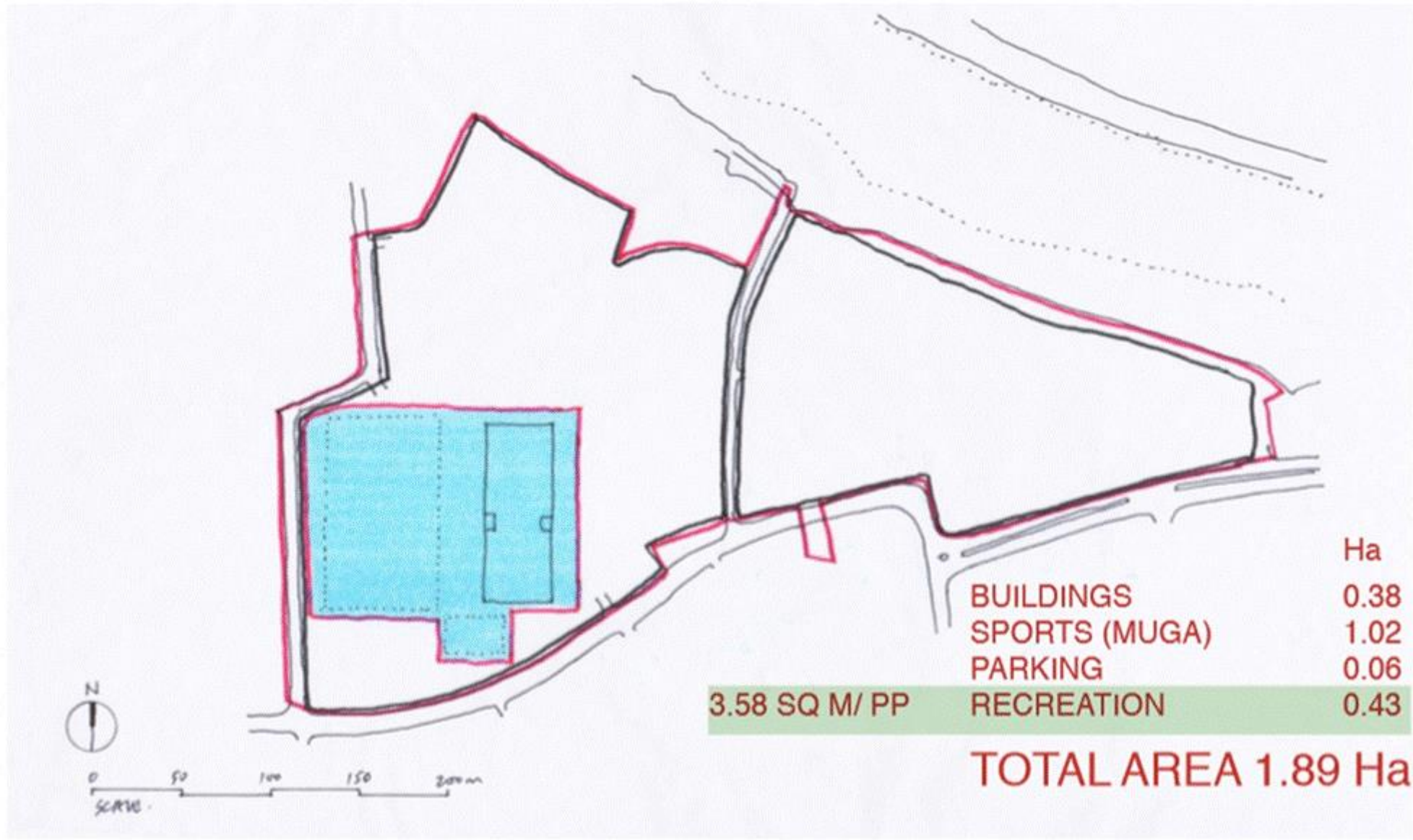

STAG BREWERY SITE – PLANNING APPLICATION



TOTAL AREA 1.89 Ha

15.75 SQM/PP

OPEN SPACE 3.58 SQM/PP

SCHOOL SITES – COMPARATIVE STUDY

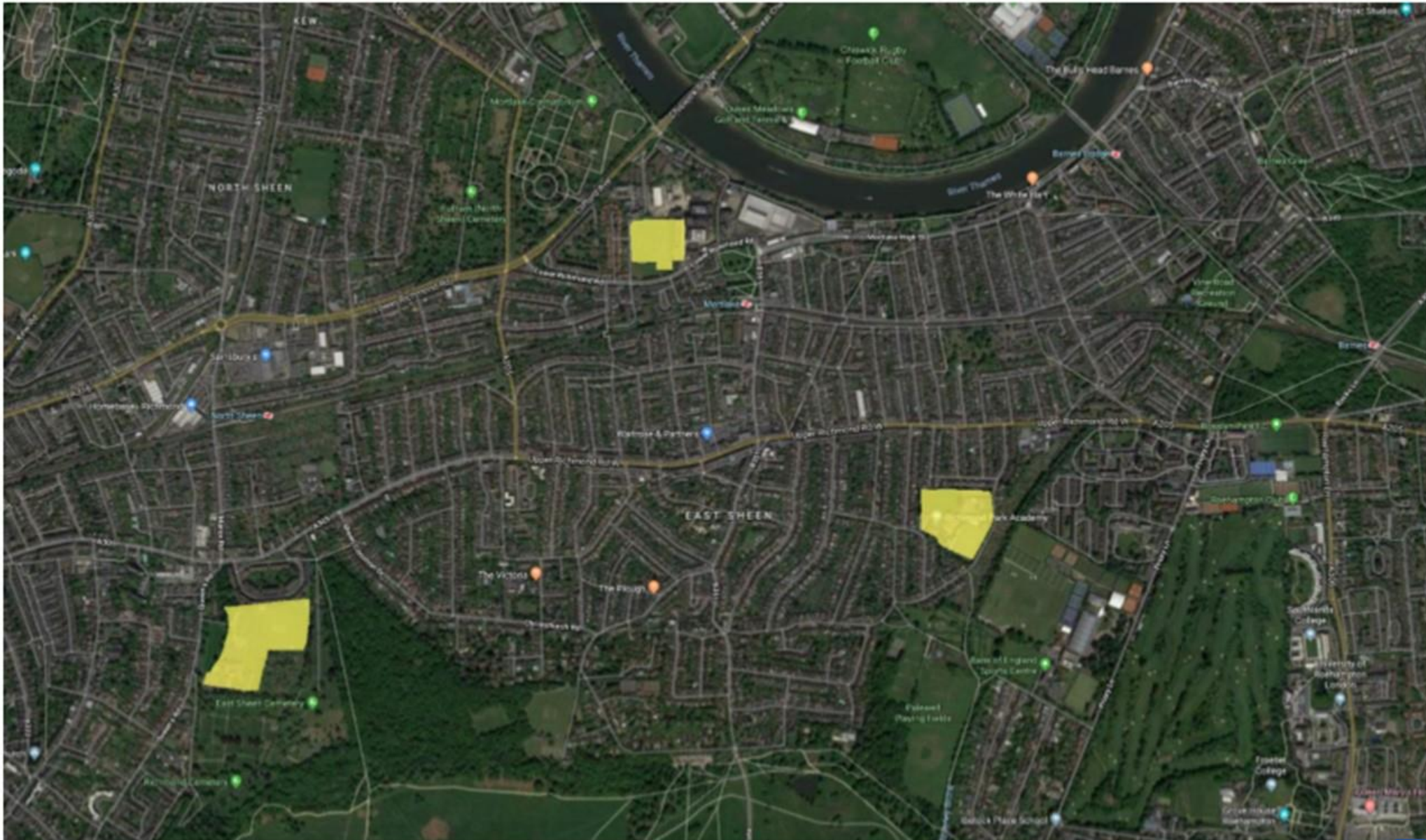

RICHMOND PARK ACADEMY

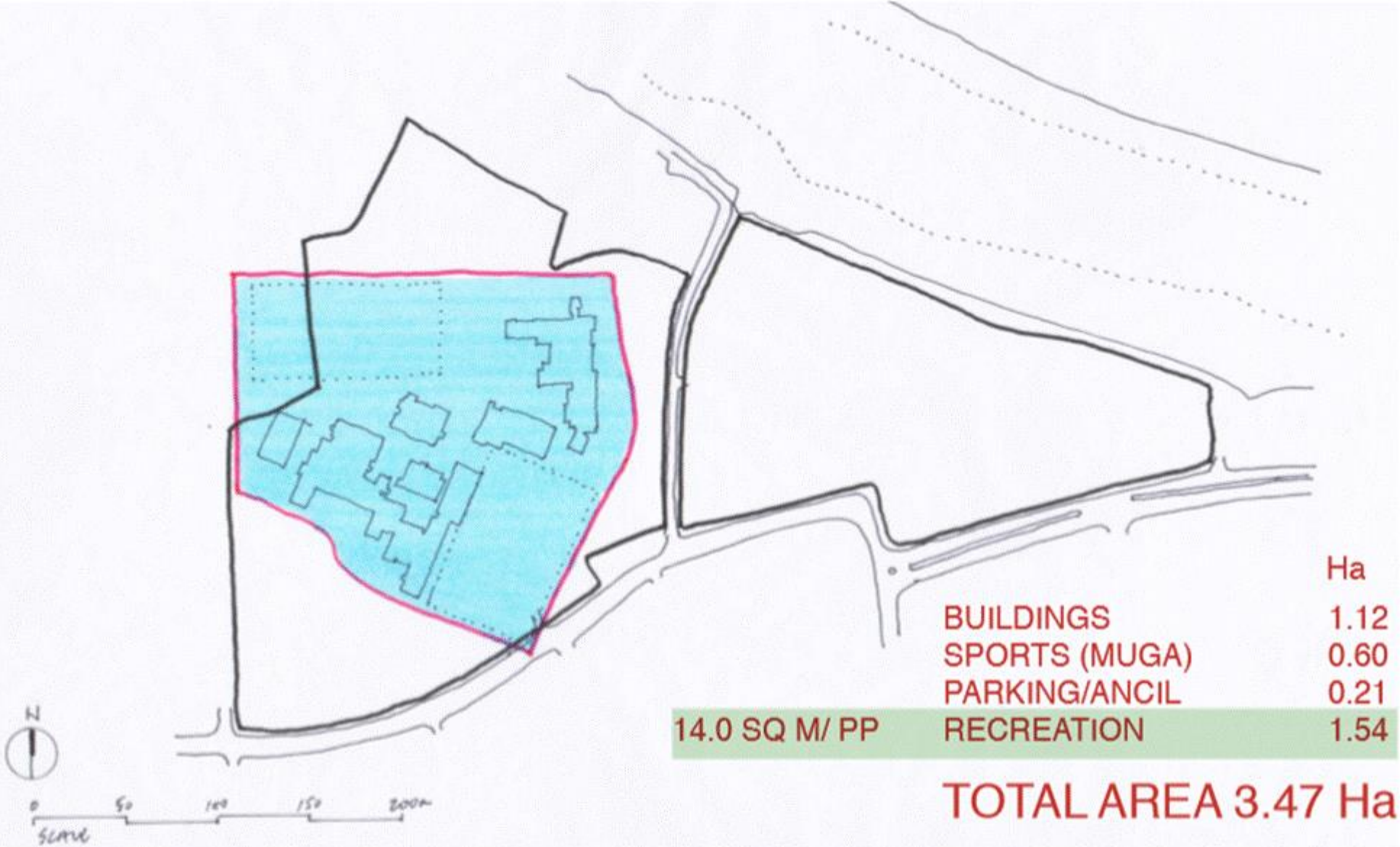

CHRIST'S SCHOOL SITE

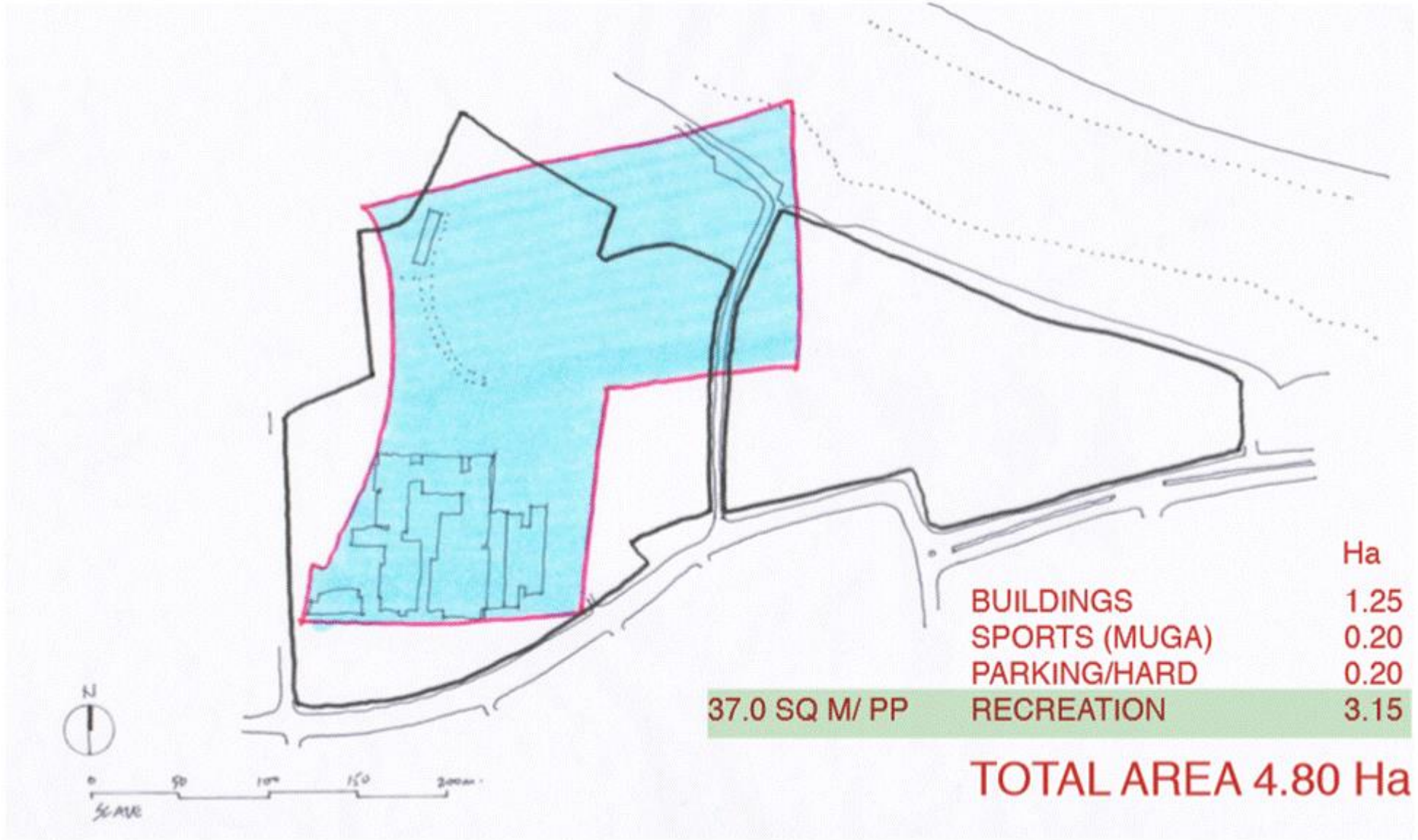

SCHOOL SITES – COMPARATIVE STUDY

STAG SITE

TOTAL AREA 1.89 Ha

15.75 SQM/PP

OPEN SPACE 3.58 SQM/PP

RPA SITE

TOTAL AREA 3.47 Ha

31.55 SQM/PP

OPEN SPACE 14.00 SQM/PP

CHRIST'S SITE

TOTAL AREA 4.80 Ha

56.47 SQM/PP

OPEN SPACE 37.00 SQM/PP

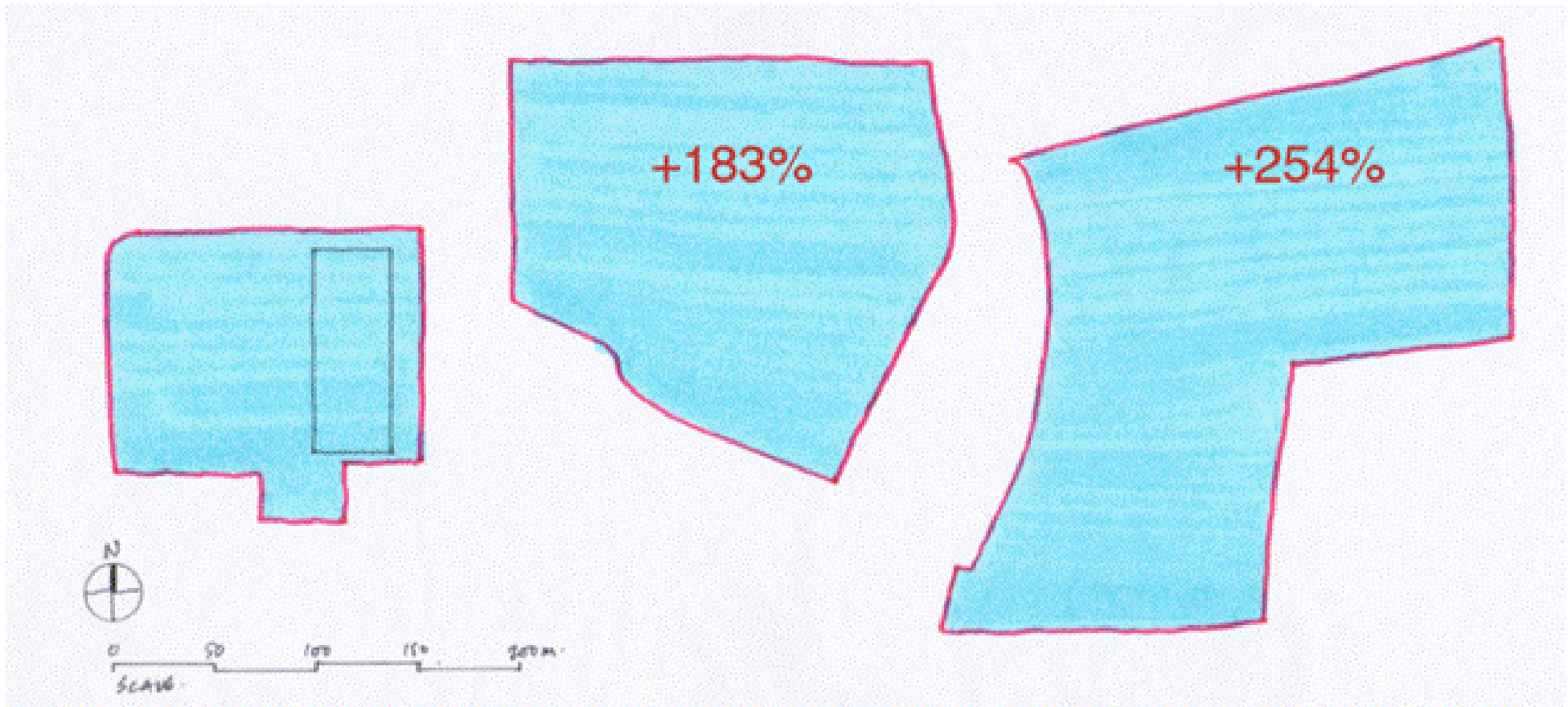

BREWERY SITE SCHOOL - CONCERNS

- Sub-Optimal Site Allocation
- Inadequate External Space
- Only 15 Car Parking Spaces
- Traffic
- Pollution - Lower Richmond Road
- School Place Demand - Alternative Solutions
- Number of Objections and GLA Comments

1. Welcome and Introductions

2. Overview and Consequence of Proposed Development

3. School Demand and Impact on Existing Schools

4. Close and Status Update

VARYING BOROUGH PREDICTIONS OF NEED

Prediction date	Predicted shortfall		Location
	2020	2022	
October 2015	150	250+	East*
Spring 2017	215	220	North-East
February 2018 (1)	215	220	North-East
February 2018 (2)	85	192	Borough
July 2018	150	180	East*
August 2018	101	144	East

BOROUGH MODEL 1 – THE PRINCIPLES

- Nine named non-Catholic primary schools
- Fixed ‘take-up rate’
- Stated estimate of out-borough demand
- Predicted combined shortfall at Christ’s and RPA

MODEL 1 : SECONDARY SHORTFALL IN THE NORTH-EAST

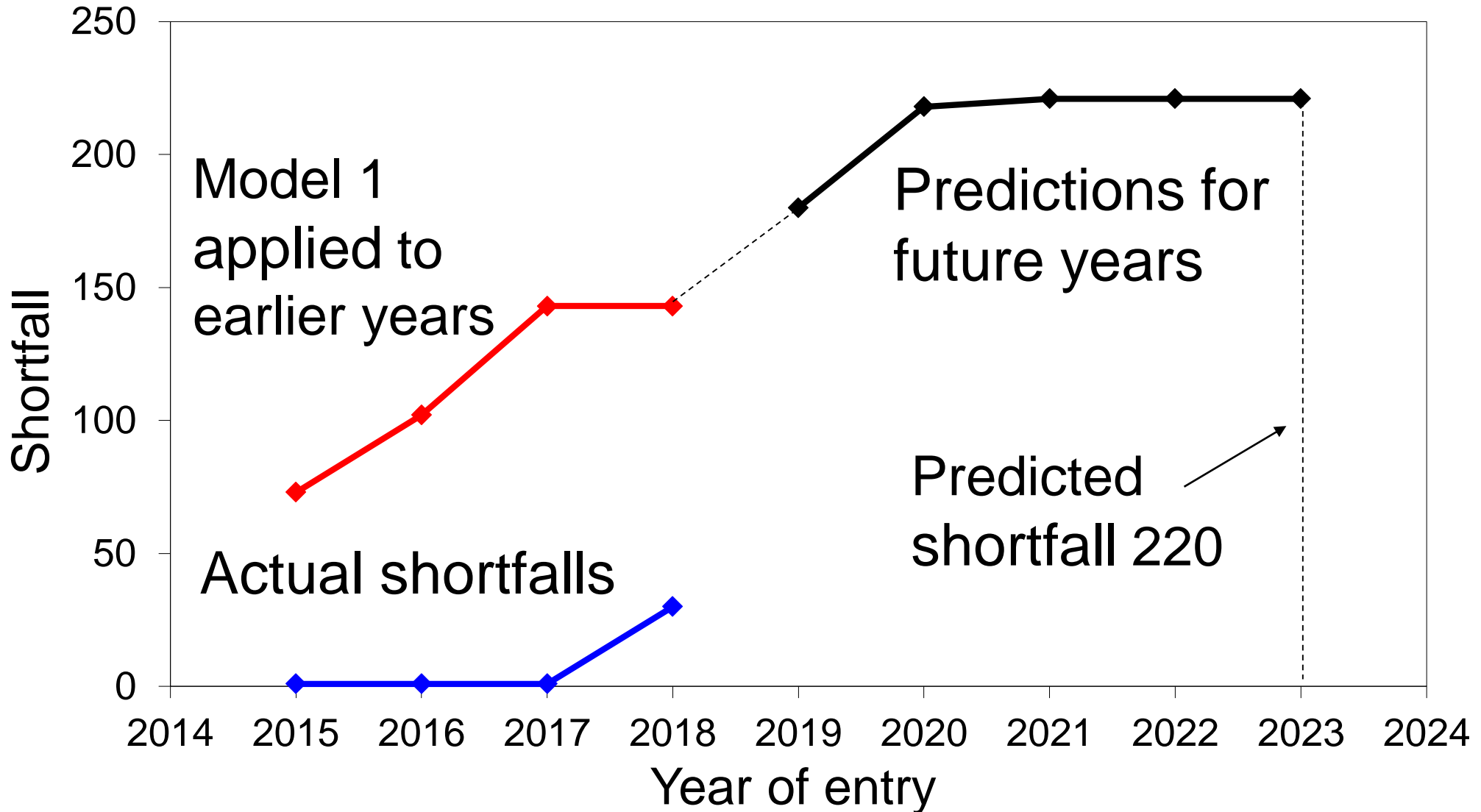

BOROUGH MODEL 2 – THE PRINCIPLES

	2018	2019	2020	2021	2022	2023	2024
Year 6	765	782	856	908	911	922	909
Est. need	600	612	671	712	714	722	713

Total Year 6 leavers for 2018 765

Total Year 7 intake for 2018 600

$$600 \div 765 = 78.4\%$$

Total Year 6 leavers for 2019 782

$$782 \times 78.4\% = 612$$

MODEL 2 WITH CONSTANT OUT-BOROUGH DEMAND

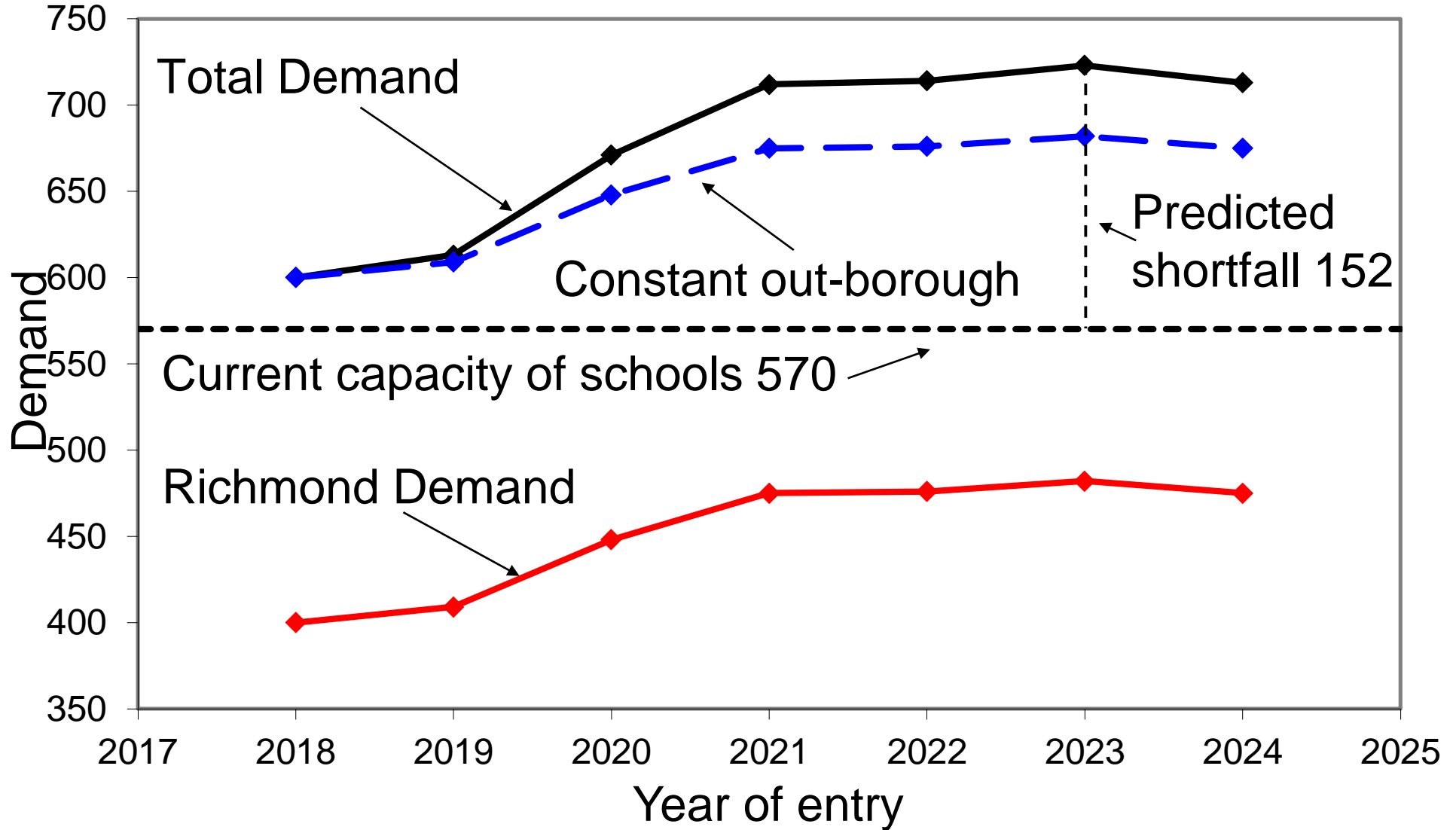

CENSUS BASED ADJUSTMENTS TO THE DATA

Year of entry	2018		2023
Year 6 leavers (M2)	765		922
October census	759		885
Catholic leavers	110		118
Non-Catholic leavers	649		767
Year 7 demand (M2)	376		453
Year 7 demand (MBCG)	363		429

DEMAND FROM PRIMARY LEAVERS IN THE EAST

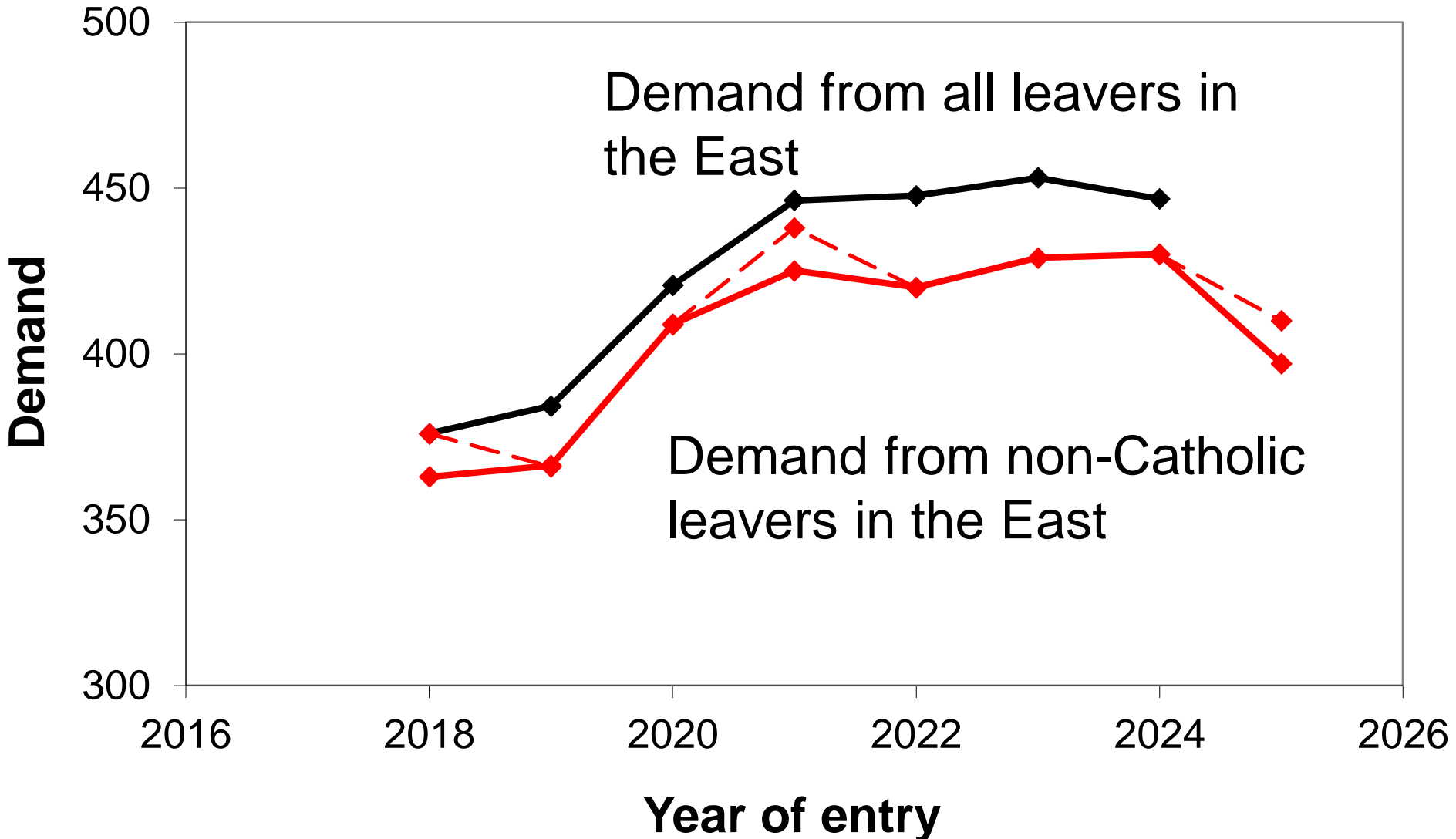

MORE ON OUT-BOROUGH INTAKE

- Christ's School has increased its offer of Open places from 75 to 100 per year
- RPA's percentage of out-borough intake has fallen continuously since 2013 and is now below 30%
- Grey Court has benefited from increased popularity of Kingston Academy. Its out-borough intake fell from 60% in 2016 to 40%, or about 100 students, in 2018
- Expanding a school may increase its out-borough intake proportionately

TWO MODELS OF SECONDARY DEMAND IN THE EAST

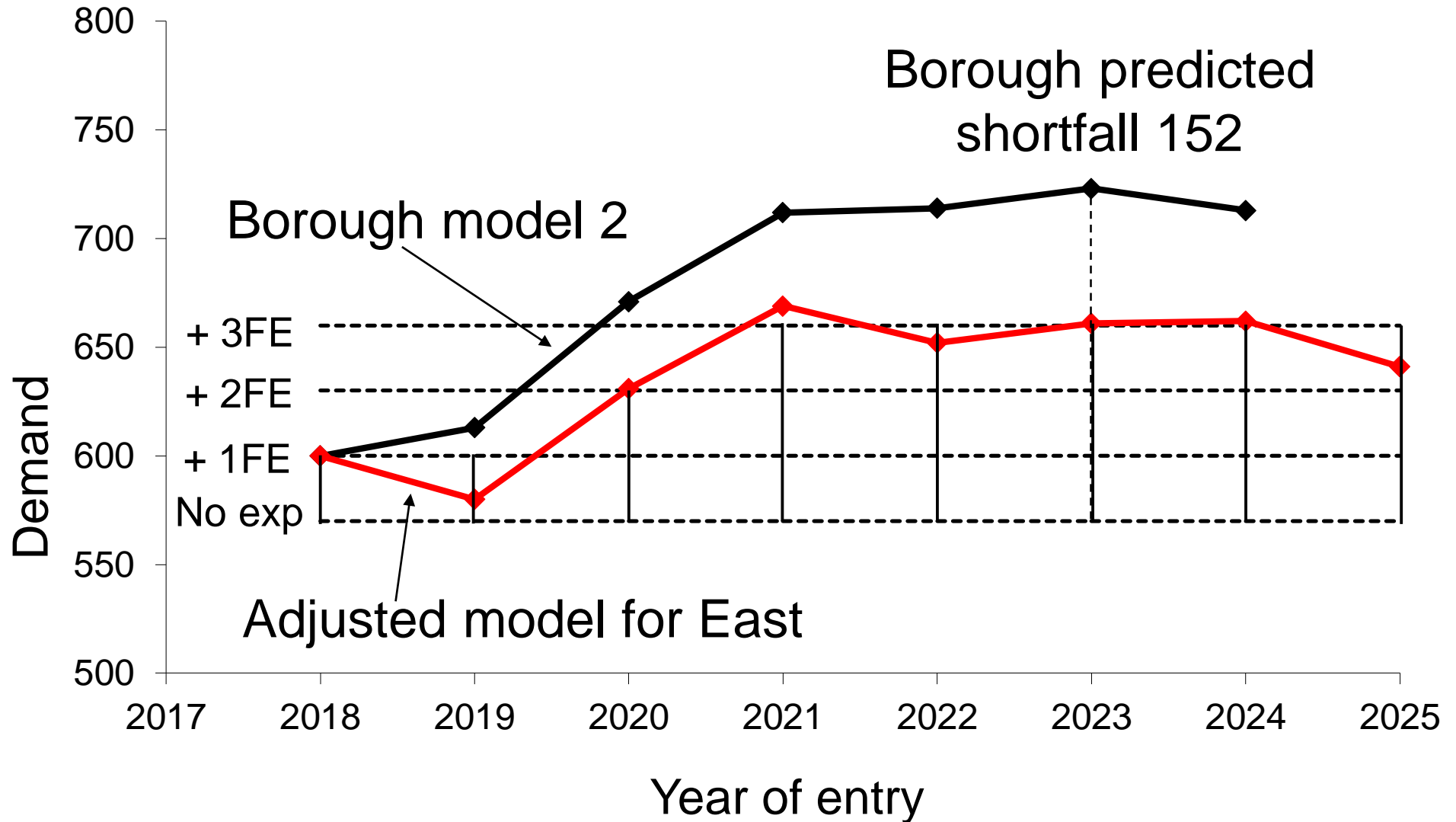

WHY ARE WE UNCONVINCED?

- Council estimates of future demand have fallen significantly since 2015
- The evidence of demand in the NE is now hidden
- Data reveal a plateau in secondary demand in the east from 2021
- After 2024, secondary demand in the east begins to fall
- Any increased demand from the Kingston area should be dealt with locally, not in Mortlake

1. Welcome and Introductions

2. Overview and Consequence of Proposed Development

3. School Demand and **Impact on Existing Schools**

4. Close and Status Update

KEY QUESTIONS

- Does it matter if we have an over-supply of secondary school places?
- What happens if sixth forms are too small?
- What are the conditions for sixth form viability?

THE CURRENT GOVERNMENT POSITION ON THE SIZE OF SIXTH FORMS

“We will only approve a secondary school with a sixth form where **the proposed sixth form will provide places for a minimum of 200 students.**

(This is in order to) ensure that we get the maximum value from the investment of capital funding, and to improve **the educational and financial sustainability of your school**

Source: “How to apply to set up a mainstream free school” Para 9.8 (Department for Education, Updated July 2018.)

STAYING ON POST-16 – THE NATIONAL PICTURE

- State funded schools and colleges:
 - Colleges – 45%
 - Schools – 35%
- Independent (fee paying) schools – 7%
- Apprenticeships – 4%
- NEET – 4%

WHY MIGHT 16 YEAR OLDS LEAVE THEIR SCHOOL AT 16?

- Because they do not qualify to enter the sixth form
- To have a change of environment after 5 years in one place
- In order to take subjects or combinations of subjects not available where they are
- On order to follow a vocational programme, requiring:
 - Special facilities
 - Teachers with industrial/commercial experience

THE IMPLICATIONS OF STUDENT CHOICE POST-16

- In a non-selective school there is an inevitable reduction in school numbers after the GCSE year.
- This reduction tends to be greater when sixth forms are small.
- Participation in education or training is now compulsory until 18, but funding per head has reduced significantly.
- So viability is more at risk

WHAT HAPPENS IF A SIXTH FORM IS TOO SMALL?

- The government view is that to provide adequate choice at least 15 A level subjects need to be offered
- If this is not possible then a higher than average number of students will go elsewhere
- In this case the sixth form will get even smaller
- A **downward spiral** can result

THIS IS NOT JUST A THEORETICAL PROBLEM

- In Richmond, on the Twickenham side of the river, five schools opened new sixth forms after 2014.
- Two of the five no longer have independent sixth form provision.
- The other three schools all have at least 7 forms of entry (210 p.a.) and two are outstanding.
- An academy elsewhere in South London is presently consulting on closing its sixth form. It provides an interesting case-study.

FORMS OF ENTRY AND SIXTH FORMS

- The schools with sixth forms of 200 pupils or more all have an intake at 11 of at least 7 forms of entry
- RPA and Christ's School are still growing towards this number
- The proposed school on the brewery site is planning for a sixth form of 250, but only 6 forms of entry
- Will it therefore aim to recruit students at 16 from other schools?

CASE STUDY

CASE STUDY: Harris Academy Peckham

Their public consultation about sixth form closure

- *Government advice to schools establishing new sixth forms is that to be financially viable, they require a minimum of 200 students.*
- *There are currently just 119 students in the sixth form of Harris Academy Peckham, across Year 12 and Year 13.*
- *We feel that it is not right to be spending funds meant to be for under-16s on subsidising unviable sixth form courses.*
- *A sixth form class needs to have about 14 students in it to be financially viable. But, currently, none of our Year 13 groups has this number of students*

ACHIEVING VIABLE SIXTH FORMS

Forms of entry	Year group size	Staying on rate at 16	Sixth form size
6	180	35%	126
6	180	45%	160
8	240	45%	216
6	180	69%	250

35% is national average, 45% is Richmond's best, 69% is prediction for Brewery site

AN ALTERNATIVE: EXPANDING EXISTING SCHOOLS

- Both are “good” schools (Ofsted)
- Both sixth forms are growing
- Expansion would underpin their viability
- Over provision would put viability at risk
- Both are on significantly larger sites than is being provided for a school on the Brewery development
- Both also have playing fields very close at hand
- Fewer transport issues

POTENTIAL BARRIERS TO EXPANSION

- Willingness?
 - One school would like to expand by two forms of entry
 - One is willing to consider one extra if required.
- Planning?
 - There is adequate space to expand
 - Subject to normal planning process
- Money?
 - Income (for running costs) is generated from central government by pupil recruitment
 - **Capital funding for new buildings?**

FUNDING ADDITIONAL PLACES GOVERNMENT GUIDELINES

*“Basic need allocations are paid to local authorities (LAs) to support the capital requirement for providing new pupil places by **expanding existing maintained schools, free schools or academies**, and by establishing new schools.”*

Source: Department for Education 2018

(A “basic need” exists when the places are required to enable a Local Authority to meet its obligation to provide enough school places.)

AGENDA

1. Welcome and Introductions
2. Overview and Consequence of Proposed Development
3. School Demand and Impact on Existing Schools
- 4. Close and Status Update**

CONSIDERING THE ALTERNATIVES

- Current Proposal
- Expansion
- Smaller Secondary
- Primary School
- No School

ALTERNATIVE OPTION - BENEFITS

- Green space and sports fields retained
- Congestion and pollution impact reduced
- Safety concerns at Sheen Lane level crossing alleviated
- Chalker's Corner not necessary and Chertsey Court residents unaffected
- School places delivered for less and opportunity to relocate primary school
- Increased funds available for S106
- Opportunity created for more affordable housing

WHO IS BIDDING FOR THE NEW SCHOOL?

1. The Livingstone Academy

- Sponsored by the Aspirations Academies Trust
- Approved (2016) for Tower Hamlets.
- Its description has not yet been updated for Mortlake

2. The Thomas Cromwell School

- Faith School based on Fulham Boys School
- Not supported by the Diocese of Southwark.

Before the Education and Skills Funding Agency can draw up a funding agreement for a new Free School after it is approved, it is legally required to consult with local stakeholders, including community interests and other schools.

TRANSPARENCY IS REQUIRED

Waiting for the Education and Skills Funding Agency consultation is too late, we want the council to:

- Publicly respond to the GLA “...to ensure that there is a robust and evidenced case...” to justify a secondary school
- Consult with the local residents and demonstrate that the other options such as expansion have been adequately and fairly considered
- Demonstrate how the localised demand for primary school places will be delivered
- To not resolve planning on the school application until this has been completed

Mortlake Brewery Community Group

Close

ALTERNATIVE PLAN

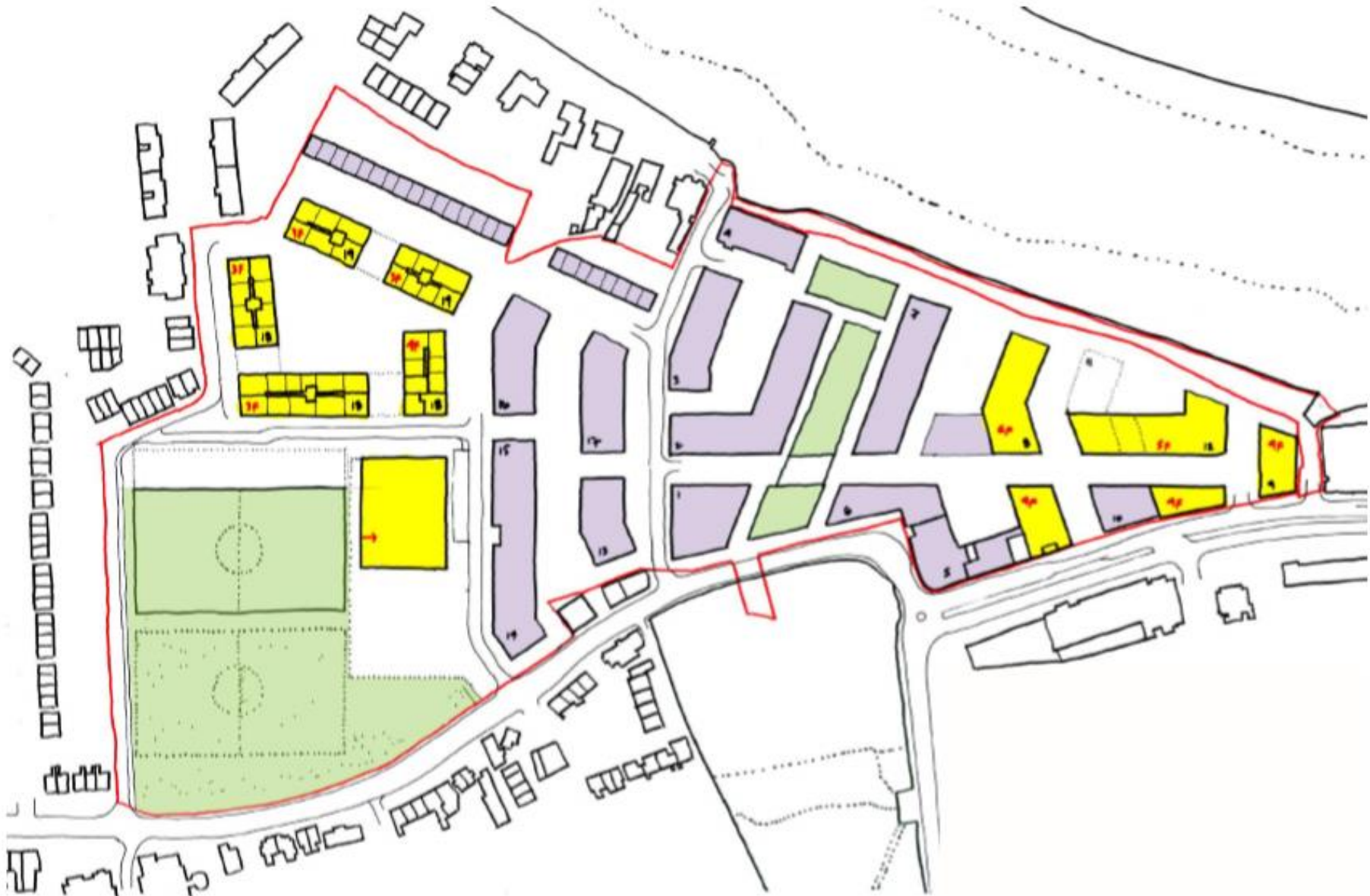

ALTERNATIVE PLAN



- EAST**
- REDUCE SCALE OF BUILDINGS IN EAST ZONE ADJACENT TOWPATH + HIGH STREET, HEIGHTS TO COMPLY WITH PLANNING BRIEF
 - IMPROVE RESIDENTIAL LAYOUTS IN EAST ZONE
 - REMOVE RAMPTO CAR PARK ON HIGH STREET

- WEST**
- REDUCE SCALE OF BUILDINGS IN NW ZONE, HEIGHTS TO COMPLY WITH PLANNING BRIEF
 - REDUCE FOOTPRINTS
 - REDUCE SCHOOL TO PRIMARY PROVISION
 - RETAIN COLT SPORTS FIELDS

- GENERAL NOTES**
- REDUCE PARKING PROVISION OVER WHOLE SITE
 - AFFORDABLE PROVISION TO EAST + WEST
 - IMPROVE COMMUNITY PROVISION (MALTINGS)

RICHMOND PARK ACADEMY – EXPANSION POTENTIAL

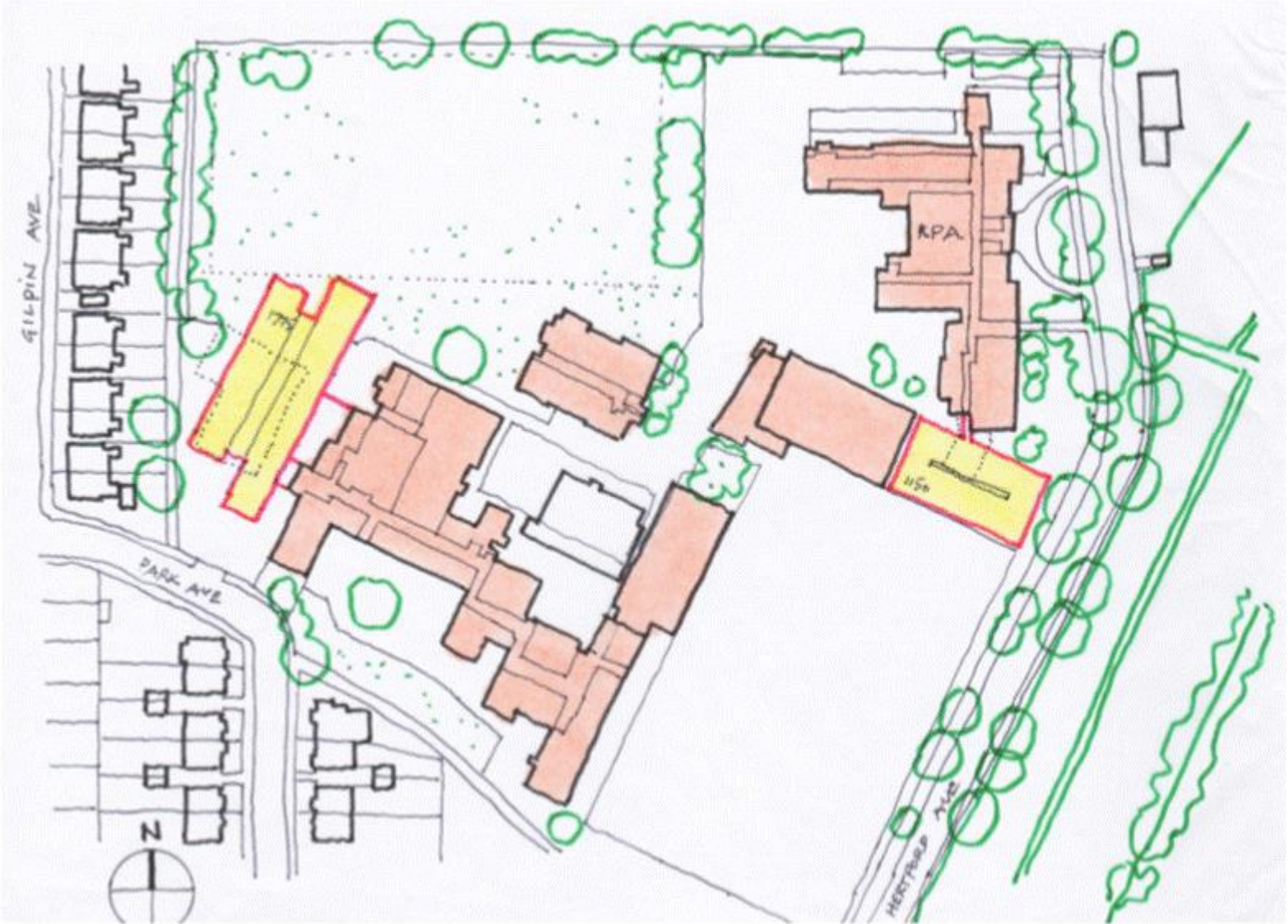

CHRIST'S – EXPANSION POTENTIAL

